

17501

16117

4 Hours / 100 Marks

Seat No.

--	--	--	--	--	--	--	--

- Instructions :**
- (1) All Questions are *compulsory*.
 - (2) Answer each next main Question on a new page.
 - (3) Illustrate your answers with neat sketches wherever necessary.
 - (4) Figures to the right indicate full marks.
 - (5) Assume suitable data, if necessary.

Marks

1. (A) Attempt any **THREE** of the following : **12**

- (a) What is estimating & costing and state two purpose of estimating & costing.
- (b) State the local rate of following materials :
Murrum, Traditional Bricks, Cement, Rubble
- (c) State the units of measurement for following item of work :
Flooring, concrete, basin & plastering.
- (d) List different types of detailed estimate.

(B) Attempt any **TWO** of the following : **08**

- (a) What is bar bending schedule ? State any two advantages of preparing bar bending schedule.
- (b) State Rules of Deduction as per IS 1200 for
 - (i) Brickwork for walls.
 - (ii) Painting work (Internal)
- (c) State situation under the following estimates prepared :
 - (i) Revised estimate
 - (ii) Approximate estimate

2. Attempt any TWO of the following : 16

- (a) Describe the procedure for preparation of approximate estimate of an irrigation project.
- (b) Describe the procedure for preparing approximate estimate of road project.
- (c) Prepare approximate estimate of a bridge having 5 spans of 40 m each using following data :
 - (i) Cost of existing bridge ₹ 1.2 cr.
 - (ii) Existing bridge having 3 span of 50 m each.

3. Attempt any FOUR of the following : 16

- (a) Prepare check-list of R.C.C. framed structure for preparing a detailed estimate.
- (b) What is prime cost & pay work ?
- (c) A R.C.C. Lintel size 250×150 mm & clear span of 1.5 m is reinforced with 4 bars of 10 mm ϕ @ bottom & 3 bars of 8 mm ϕ @ top. The stirrups of 6 mm ϕ are provided 150 mm c/c. Bearing of lintel is 150 mm. Calculate the total quantity of steel reinforcement.
- (d) Explain the long wall & short wall method for taking out quantities.
- (e) What is work charged establishment & contingencies ?

4. Attempt any TWO of the following : 16

- (a) State and explain four factors affecting rate of an item.
- (b) Prepare rate analysis for U.C-R masonry in C.M. (1:5) for foundation.
- (c) Prepare rate analysis for B.B. masonry in C.M. (1:6) 300 mm thick wall.

5. Attempt any TWO of the following :

16

- (a) Find quantity of brickwork, P.C.C., excavation and internal plaster for a underground water tank. (Fig. 1)

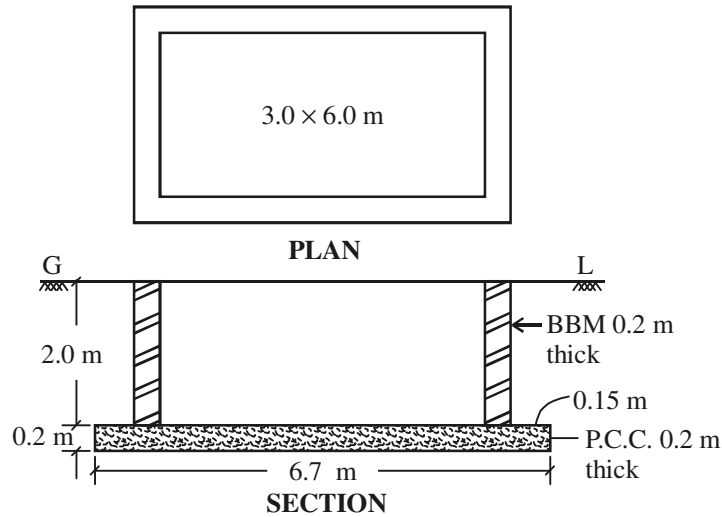

All dimensions are in metre.

Fig. 1

- (b) Work out the quantity of following items for septic tank having internal size 1.5 m × 3.5 m and height 1.50 m. The top of slab of septic tank is 20 cm above ground level.

- (i) Earthwork in excavation.
- (ii) P.C.C. (M15) 15 cm thick
- (iii) B.B. masonry in C.M. (1:6) 300 mm thick.
- (iv) R.C.C. slab M20 on septic tank 12 mm thick

15 cm offset is provided for P.C.C. on all sides of septic tank.

P.T.O.

- (c) Work out the quantity of concrete and steel in footing for RCC column given in (see fig.-2) using following data.

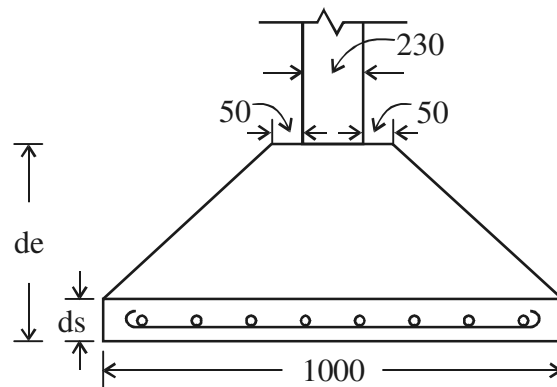

All dimensions are in mm.

Fig. – 2

Column	No.	Column Size	Footing size	de/ds	Footing reinforcement
C ₂	07	230 × 300	1000 × 1200	350/150	10φ@150 c/c both way

Assume suitable cover to the reinforcement.

6. Attempt any FOUR of the following :

16

- Prepare rate analysis for mosaic tile flooring 20 mm thick.
- Explain the factors to be considered in preparation of detailed estimate.
- What are the different methods used for calculation of earthwork quantities for road & canal ? Explain any one.
- What is task work ? State any three factors affecting task work.
- Explain the procedure for preparation of detailed estimate for a small R.C.C. slab culvert.
- Describe the procedure for preparing rate analysis.